

Sysgration Design and Manufacturing Services (DMS) for Mobile Data Terminal

Reference Design Specification

- 7" 1024 x 600 High Brightness w/ P-Cap Touch
- i.MX8M Plus
- 16GB eMMC
- 2GB RAM
- 4G LTE Cat 4 + GPS
- 802.11a/b/g/n/ac + BT5.0
- J1939, CAN 2.0
- CVBS Video Input
- Integrated 2W speaker + Microphone
- 9-32VDC in, ISO7637
- IP54
- -20 ~ 75 °C
- SAEJ1455



Supporting various vehicle mount solutions

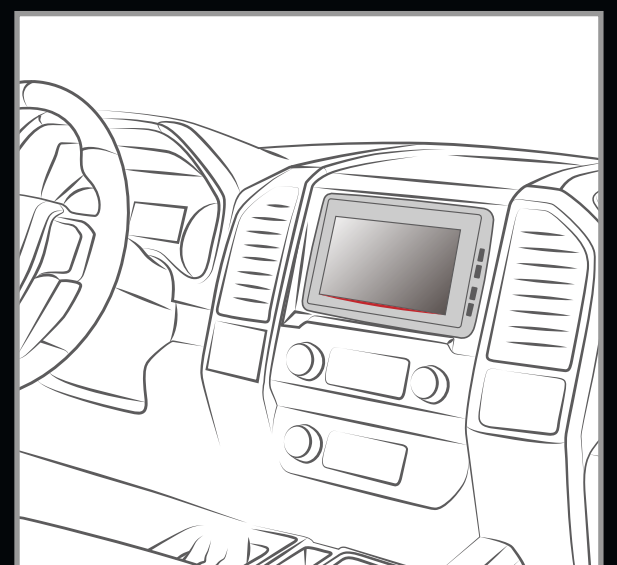
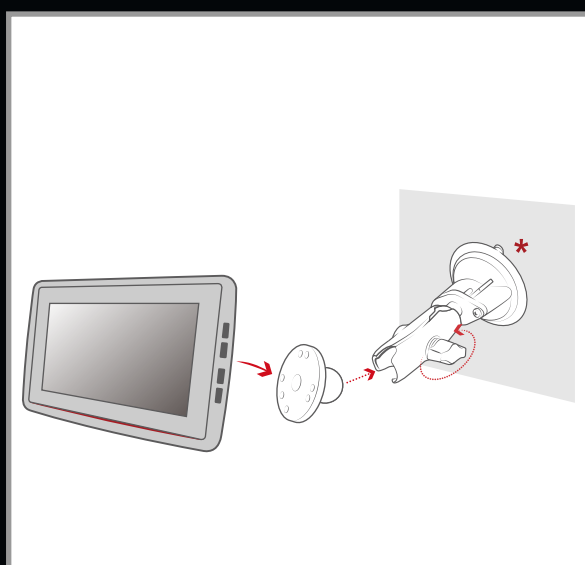
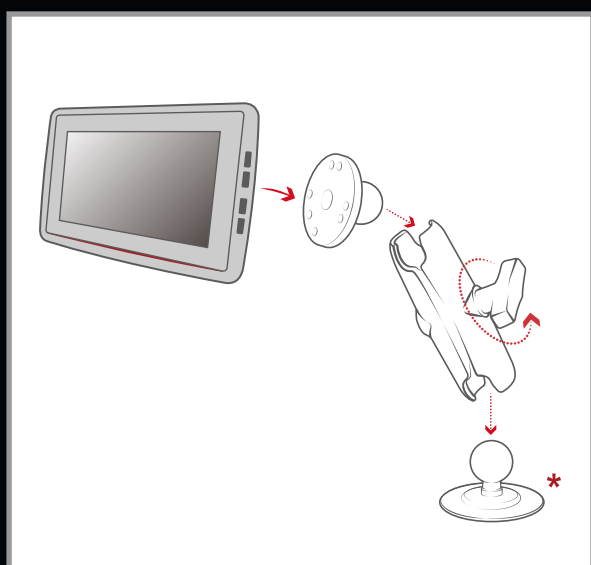

*mounting solutions illustrations are from RAM Mounts